

CPS 833/1

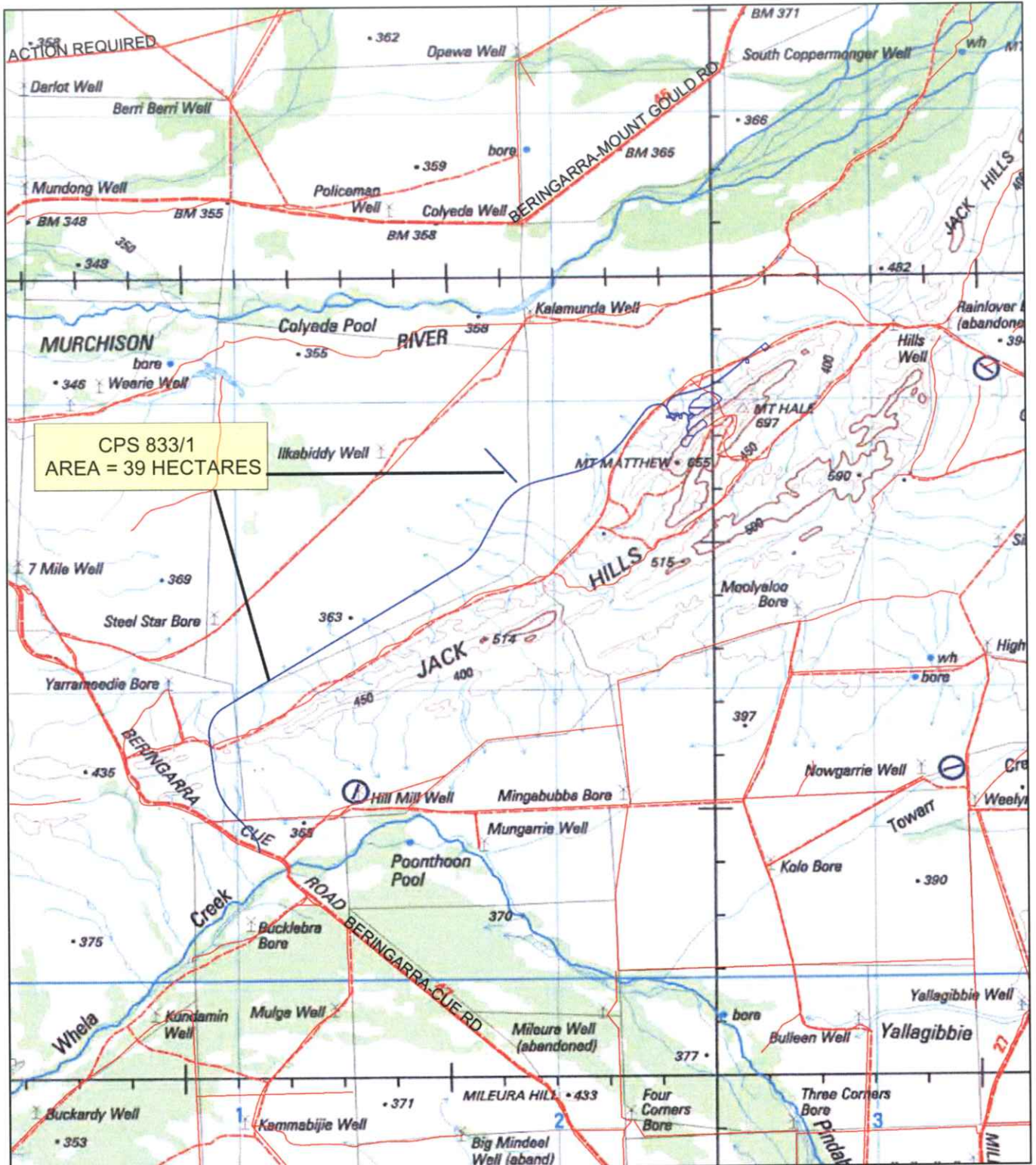

CPS 833/1
AREA = 39 HECTARES

LEGEND

-  Road Centrelines - DLI 1/5/04
-  Areas Subject to Conditions
-  Areas Approved to Clear
-  Cadastre - DLI 1/09/05
-  NATMAP 250K Series Mapping - GA 08/03
-  Clearing Instruments
-  Areas Applied to Clear (cont)



0 ————— 5 km

Scale 1:189486
(Approximate when reproduced at A4)

Geocentric Datum Australia 1994

Note: the data in this map have not been projected. This may result in geometric distortion or measurement inaccuracies.

Prepared by: MIENVRM
Prepared for:
Date: 18/11/2005 8:25:05 AM

Information derived from this map should be confirmed with the data custodian acknowledged by the agency acronym in the legend.



Department of Environment

WA Crown Copyright 2002

CPS 833/1

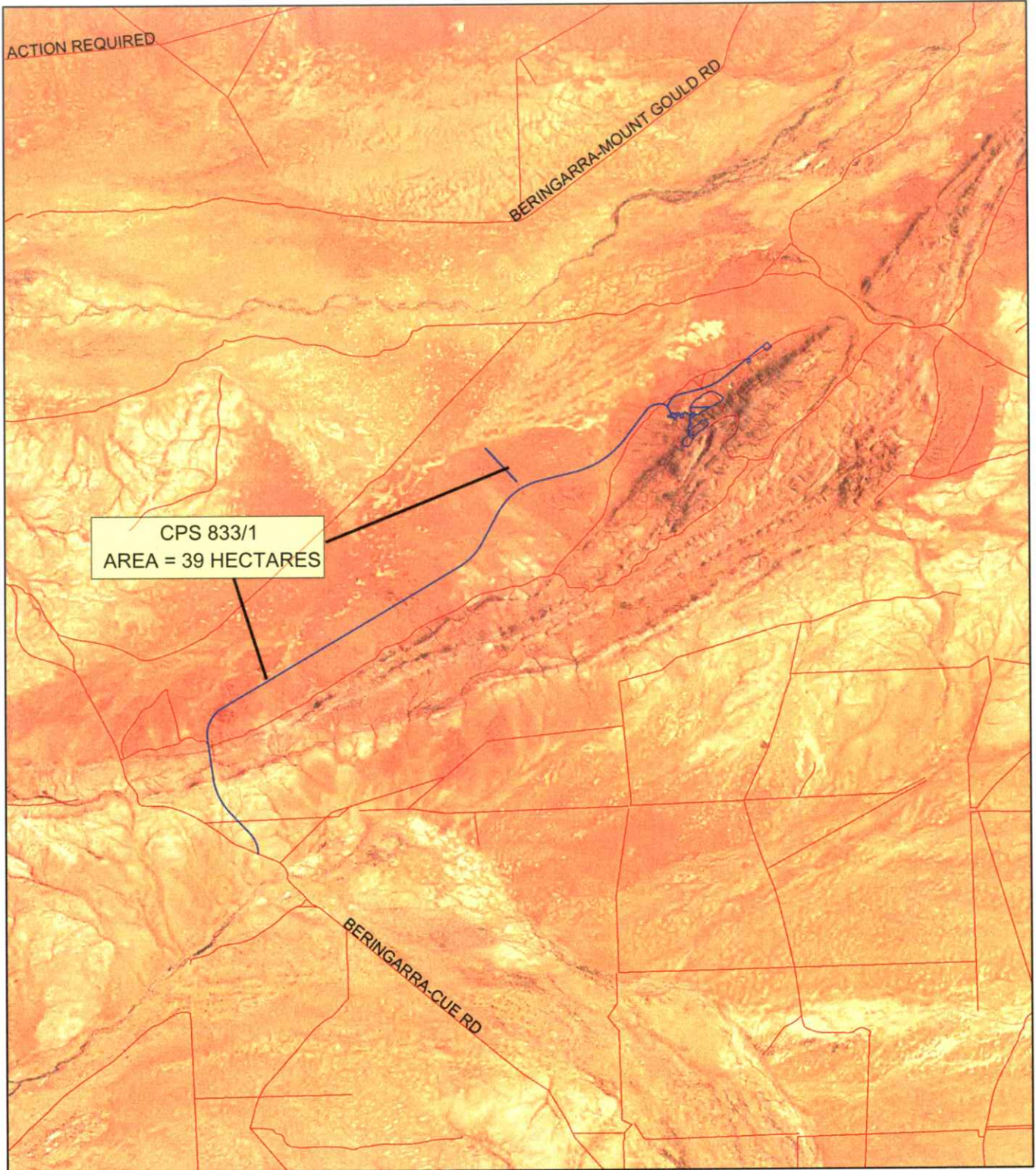

LEGEND

✓ Road Centrelines - DLI
1/5/04

□ Cadastre - DLI 1/09/05
Clearing Instruments

▨ Areas Applied to Clear
(cont)

▨ Areas Subject to Conditions
▨ Areas Approved to Clear

Western Australia ETM 25m
543 - AGO 04



0 ————— 5 km

Scale 1:189486

(Approximate when reproduced at A4)

Geocentric Datum Australia 1994

Note: the data in this map have not been projected. This may result in geometric distortion or measurement inaccuracies.

Prepared by: MIENVRM

Prepared for:

Date: 18/11/2005 8:33:51 AM

Information derived from this map should be confirmed with the data custodian acknowledged by the agency acronym in the legend.



Department of
Environment

WA Crown Copyright 2002